

WIZARD C2 PRO

MULTI FLASHLIGHT

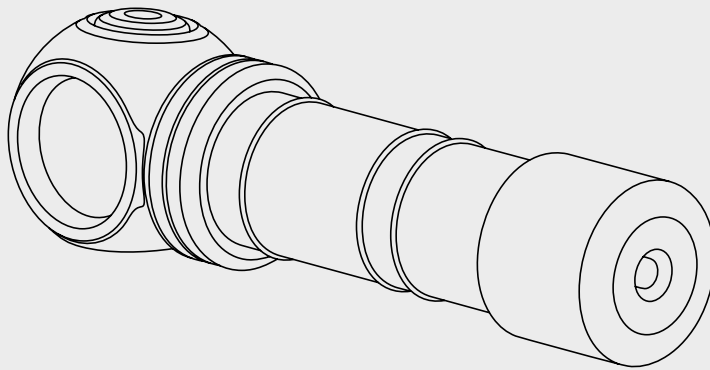

ENG USER MANUAL

Thank you for choosing the products of Armytek Optoelectronics Inc.
Please read this manual carefully before using the flashlight.

Specifications

Headlamp: simple one-hand operation, reliable headmount for running. Solid body without long wires, weak rubber connectors and unnecessary boxes. The flashlight is easily installed, removed and 180° rotatable in the mount. Quick-release rubber ring provides additional fixation

Every Day Carry light: compact design, convenient side button, special matt anti-abrasive finish without rough knurling, strong built-in magnet and robust steel clip, constant light without flickering

Bicycle light: made from aircraft-grade aluminium, durable quick-release mount in the set

- Powerful electronics provides impressive light output up to 2500 lumens and record 200 days in Firefly mode
- Total protection from water, dirt and dust – flashlight continues to work even at 10 meters depth
- Convenient wide beam of the TIR-optics, protected from scratches by tempered glass with anti-reflective coating

- Innovative technology allows to use any 18650 batteries and provides full protection against short circuit even in case of contact between magnetic connector and metal objects
- Active real-time temperature control to prevent overheating above 58 °C and warning indication of low battery level
- Multicolor temperature and battery state indication for 25 years helps to find the flashlight in the dark
- Robust and water resistant magnetic connector

WIZARD C2 PRO NICHIA

- Close to sunlight LED lighting with high CRI >90 and color temperature of 4500K for near to perfect natural color reproduction
- Incredibly powerful for the given color tint light output of 1400 lumens

		Wizard C2 Pro (White)	Wizard C2 Pro Nichia (Warm)
LED/Optics		Cree XHP50.2/TIR	Nichia NV4L144/TIR
Brightness stabilization type			FULL (constant light)
Light output		2500 lm	1400 lm
Peak beam intensity		4260 cd	2350 cd
Hotspot : Spill			70°:120°
Beam distance		131 m	97 m
Modes/Runtimes	Turbo3	2500 lm/2 h 40 min (650 lm after 30 sec)	—
	Turbo2	1750 lm/2 h 45 min (650 lm after 2 min)	1400 lm/2 h 50 min (460 lm after 1 min)
	Turbo1	870 lm/2 h 50 min (650 lm after 9 min)	770 lm/1 h 50 min
	Main3	370 lm/5 h 15 min	335 lm/4 h 10 min
	Main2	160 lm/12 h 15 min	140 lm/10 h
	Main1	45 lm/43 h	27 lm/50 h
	Firefly3	6 lm/12 d	5 lm/8 d
	Firefly2	1.5 lm/40 d	1.2 lm/40 d
	Firefly1	0.15 lm/200 d	0.1 lm/200 d
	Strobe3	2500 lm/10 Hz/5 h 45 min (650 lm after 100 sec)	1400 lm/10 Hz/5 h 40 min (460 lm after 2 min)
	Strobe2	2500 lm/1Hz/12 h (650 lm after 9 min)	1400 lm/1 Hz/14 h (460 lm after 5 min)
	Strobe1	160 lm/1 Hz /55 h	140 lm/1 Hz/50 h
Power source		1x18650 Li-Ion	
Length/Body diameter/Head diameter		112 mm/20.4 mm/33 mm	
Weight without/with battery		65 g/115 g	
Submersion and Impact resistance		IP68, 10 m for 2 h. Height up to 10 m	

* Light output for flashlights with Warm light is about 7% less, beam distance is about 3% less.

** All the above specifications are test results based on ANSI/NEMA FL1-2009 Standard. The tests are performed using the battery included in the set.
The data may vary due to environment, heat dissipation and other factors.

Set description

Flashlight, 18650 Li-Ion battery, magnetic USB charger, clip, head-mount, bicycle mount ABM-01, 2 spare O-rings, user manual.

Your flashlight can inconsiderably differ from the pictures in the manual. The producer reserves the right to change the package at his own discretion without modifying this manual.

Initial Service

TO SET/REPLACE BATTERY

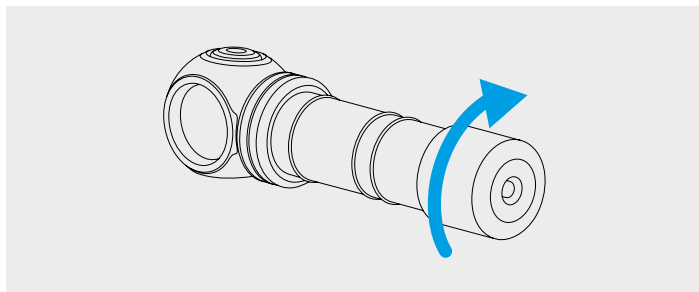

1. Unscrew the tailcap.
2. Place the battery with the positive contact (+) facing the head of the flashlight.
3. Adjust the tailcap and tighten it as far as it can go.

The flashlight is ready for operation.

HOW TO CONNECT THE MAGNETIC CHARGER

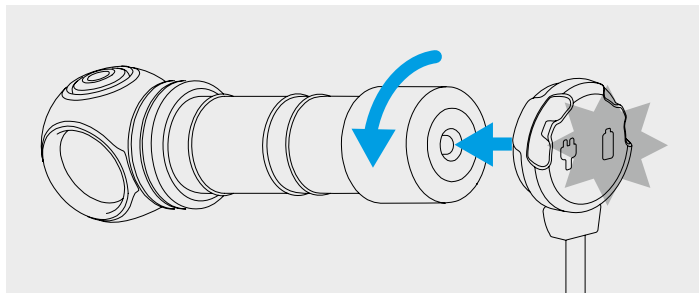

Unscrew the tailcap for 1/4 of a circle and adjust the magnetic charger to the tailcap.

CHARGER COLOR INDICATION

Charger not plugged in:

- Green — device is in waiting mode.

Charger plugged in:

- Green blinking — evaluation of battery voltage.
- Red blinking — unscrew the tailcap for 1/4 for charging.
- Orange blinking — USB power source voltage is too low for correct continuation of charging or bad contact between charger and battery.

Try cleaning the tailcap and the threads of the flashlight parts or use a different power source.

- Red — charging is going on, charging current is 1A.
- Orange — USB power source voltage is too low, charging current has been reduced by half.
- Green — charging is finished.

Operation

Before use: Tighten the tailcap.

GENERAL TYPE

Modes: Firefly1, Firefly2, Main modes, Turbo1, Turbo2 or Turbo3 (last used in Advanced, Turbo2 by default).

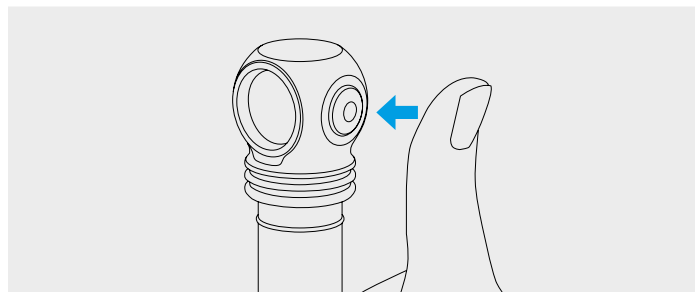

In OFF state

1 click: To turn on the last used mode.

Press and hold: To start cycling through Firefly modes. Release to select. Keeping button pressed will start cycling through Main modes.

In ON state

1 click: To turn off the flashlight.

Press and hold: To start cycling through Main modes from any mode. In Firefly1 cycling through Main modes starts after cycling through Firefly modes. Release to select.

2 clicks: To turn on Turbo mode from any mode. The second double click brings back last used mode.

ADVANCED TYPE

To switch between types of operation unscrew the tailcap to 1/4 while the flashlight is off, press the button and tighten the tailcap while keeping the button pressed.

Sections of modes:

- [1] – Firefly modes, [2] – Main modes, [3] – Turbo modes,
[4] – Strobe modes

In OFF state:

1 click: To turn on the last used mode.

Press and hold: To turn on Firefly1 mode [Section 1]. Keeping button pressed will start cycling through modes: Firefly1 – Firefly2 – Firefly3 – Main1 – Main2 – Main3 – Turbo1.

In ON state:

1 click: To turn off the flashlight.

Press and hold: To start cycling through the modes of relevant Section.

The same in OFF & ON states:

2 clicks: To turn on Main mode [Section 2]. Another double click will switch between chosen modes in [Section 1] and [Section 2].

3 clicks: To turn on Turbo mode [Section 3].

4 clicks: To turn on Strobe mode [Section 4].

Automemorizing. After switching off the last used mode is memorized for quick access at next switching on.

Safe high brightness modes. Turbo modes give maximum brightness until the temperature of the flashlight and discharge current of the battery don't exceed critical values.

Digital Light Stabilization & Safe Soft-Start System allows to increase runtime, get longer lifetime of rechargeable battery and protect it from overdischarge or overheating.

Active temperature control. When the temperature of the flashlight becomes close to critical, brightness decreases to safe value, allowing the flashlight to avoid overheating for a long period of time. In conditions of good air-cooling the flashlight delivers light without stepping down.

Warning indication shows the battery level and the temperature inside the flashlight.

Low battery level. When battery level is approximately <25%, the color LED will show the warning level by flashing orange once in 2 seconds. With further voltage reduction brightness will start to decrease in steps for safety of the battery and user. If brightness of the mode (except Firefly modes and Main1) is approximately <25% from nominal value, the main LED will flash 2 times. Critical battery level approximately <10% is indicated by flashing red once a second.

High temperature. When the temperature increases to the warning level, the color LED flashes orange 3 times once in 2 seconds. At critical level it flashes red 3 times once in 1 second. Brightness starts to reduce to safe level.

Lock-out function. Unscrew the tailcap to 1/4 for the protection from accidental switching on. State Indication will be turned off.

Multicolor State Indication. Short flashes every 4 seconds show the battery level even in OFF state (until battery level becomes lower than the critical one). The indication also helps to find the flashlight in the dark.

Switching Multicolor State Indication ON/OFF. The indication is switched off by default in Firefly modes (disabled after 10 seconds of operation) and in OFF state. To turn it on/off, unscrew the tailcap to 1/4, press the button and keeping the button pressed tighten and unscrew the tailcap again. The settings will be memorized even when battery is changed. Ultra-low current consumption allows color indication to work for maximum period of time.

⚠ Warnings

For effective operation of the flashlight we recommend branded 18650 Li-Ion batteries without PCB (unprotected) no more than 70 mm long.

The flashlight can get hot in Turbo modes, Strobe2 and Strobe3 quickly and discharge the battery with high current. Don't leave it without your attention as very bright light might heat objects and cause fire.

1. Always follow the instructions from this manual and recommendations on battery usage.
2. Apply only the recommended power sources.
3. Do not reverse battery polarity.
4. Do not modify or recast the flashlight and its components as it will deprive you of the warranty.
5. Do not allow water or any other liquid to leak into the flashlight.
6. Do not aim a switched-on flashlight at people's or animals' eyes – it can cause temporary blindness.
7. Do not allow children to use the flashlight without your assistance.

The producer will not be liable for any harm done to the user if it was caused by improper use of the product. Specifications are subject to change without notice.

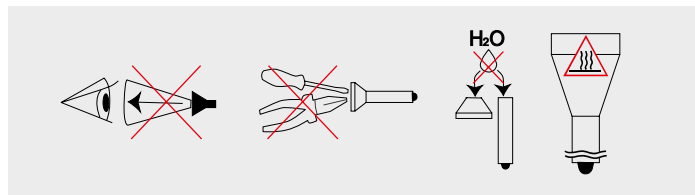

Care and Storage

It is recommended to clean the threads and O-rings off dirt and old grease once or twice per year. Remember that reliable protection from water and dust cannot be provided by worn out sealing. The fouling as well as lack of lubricant cause fast wear-out of threads and sealing rings.

TO CLEAN THE THREADS DO THE FOLLOWING:

1. Unscrew the tailcap and remove the sealing ring carefully with a toothpick (do not use sharp metal things as they can damage the ring).
2. Wipe the sealing ring thoroughly with a soft cloth (or tissue). Do not use solvents. If the sealing ring is worn out or damaged replace it by a new one.
3. Clean the metal threads with a brush using ethanol. Be careful not to allow the applied liquid to get inside the flashlight or tailcap as it can cause fails in functionality of the flashlight.

After cleaning lubricate the thread and the sealing ring with polyal-phaolefin-based silica grease, e.g. Nyogel 760G. The application of other types of grease is unacceptable. In case of active operation and exploitation in dusty environments, it is recommended to perform cleaning and lubricating of the parts as often as required.

WE DO NOT RECOMMEND

to leave power sources inside the flashlight for a long storage period, as batteries (especially non-rechargeable) can leak for various reasons and damage the inner parts of the flashlight. If you want to keep your flashlight in a stand-by state with batteries in, previously install new and high-quality batteries, store the flashlight in acceptable for batteries operational temperature and revise the batteries' state at least once a month. If you have noticed any signs of batteries' defects then withdraw them from the flashlight and utilize.

Warranty and Service

Armytek provides free warranty repairs for 10 years (excluding batteries, chargers, switches and connectors, which have 2-year warranty) from the date of purchase if there is a document confirming the purchase. The warranty does not extend to damage during:

1. Improper usage.
2. Attempts to modify or repair the flashlight by nonqualified specialists.
3. Long-term application in chlorinated and contaminated liquids or sea water.
4. Exposure to high temperatures and chemicals (including the liquids from defected batteries).
5. Usage of low-quality batteries.

Contacts

Armytek Optoelectronics Inc.
Germany, 10551 Berlin, Jonasstraße 6
+1 (206) 785-9574
service@armytek.com
www.armytek.com