



Oras Nova

INSTALLATION AND MAINTENANCE GUIDE



Water Is Worth Loving.



Accepterad
monteringsanvisning
2016:1

Contents

CZ Obsah	FI Sisällysluettelo	NL Inhoud	SE Innehållsförteckning
DE Inhaltsübersicht	FR Sommaire	NO Innhold	SK Obsah
DK Indholdsfortegnelse	IT Indice	PL Spis treści	UA Зміст
EE Sisukord	LT Turinys	RO Cuprins	
ES Contenidos	LV Saturs	RU Содержание	



Technical data	4-8
Installation	18-19
Operation.....	20
Maintenance.....	21-26
Spare parts.....	27-28

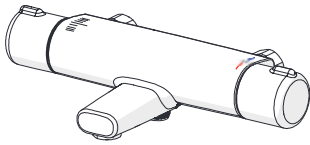

Technical data	9-11
Installation	18-19
Operation.....	20
Maintenance.....	21-26
Spare parts.....	27

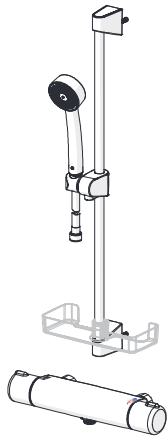

Technical data	12-17
Installation	18-19
Operation.....	20
Maintenance.....	21-26
Spare parts.....	27-28

7460

EN 1111
 I (ISO 3822) Oras lab.
 100 - 1000 kPa
 0.27 l/s (300 kPa)
 165 kPa (0.2 l/s)
 0.19 l/s (Eco-flow at 300 kPa)
 max. +80°C

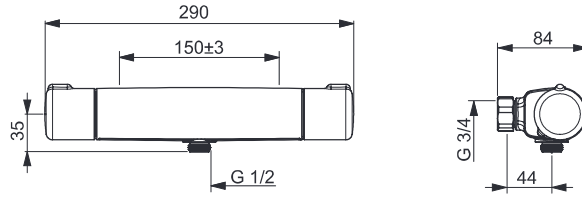

7460U

EN 1111
 I (ISO 3822) Oras lab.
 100 - 1000 kPa
 0.27 l/s (300 kPa)
 165 kPa (0.2 l/s)
 0.19 l/s (Eco-flow at 300 kPa)
 max. +80°C

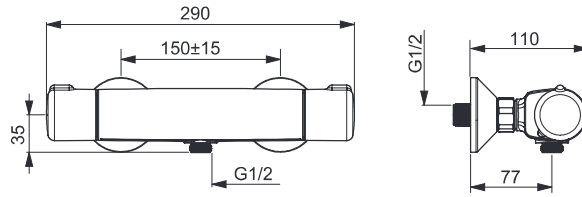

7460X

EN 1111
 I (ISO 3822) Oras lab.
 100 - 1000 kPa
 0.27 l/s (300 kPa)
 165 kPa (0.2 l/s)
 0.19 l/s (Eco-flow at 300 kPa)
 max. +80°C

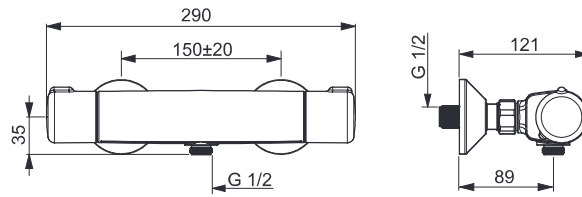

7461

EN 1111
 I (ISO 3822) Oras lab.
 100 - 1000 kPa
 0.27 l/s (300 kPa)
 165 kPa (0.2 l/s)
 0.19 l/s (Eco-flow at 300 kPa)
 max. +80°C

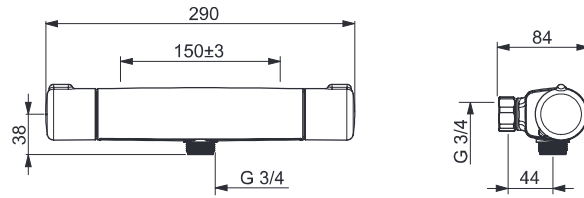

7471

EN 1111
 I (ISO 3822) Oras lab.
 100 - 1000 kPa
 0.27 l/s (300 kPa)
 165 kPa (0.2 l/s)
 0.19 l/s (Eco-flow at 300 kPa)
 max. +80°C

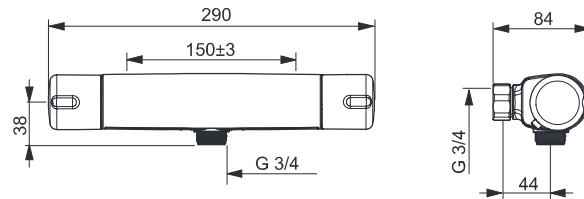

7484

EN 1111
 I (ISO 3822) Oras lab.
 100 - 1000 kPa
 0.26 l/s (300 kPa)
 180 kPa (0.2 l/s)
 0.18 l/s (Eco-flow at 300 kPa)
 max. +80°C

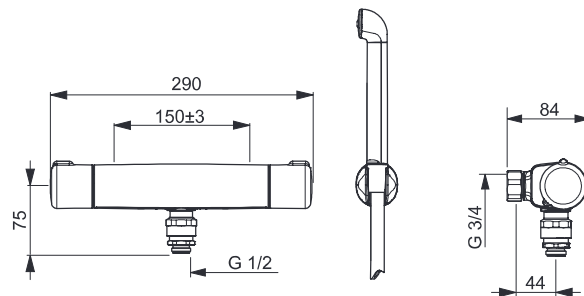

7464

EN 1111
 I (ISO 3822) Oras lab.
 100 - 1000 kPa
 0.27 l/s (300 kPa)
 165 kPa (0.2 l/s)
 0.19 l/s (Eco-flow at 300 kPa)
 max. +80°C

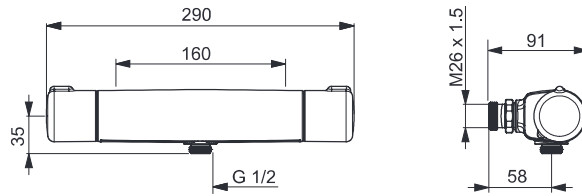

7466

EN 1111
 I (ISO 3822) Oras lab.
 100 - 1000 kPa
 0.26 l/s (300 kPa)
 180 kPa (0.2 l/s)
 0.18 l/s (Eco-flow at 300 kPa)
 max. +80°C

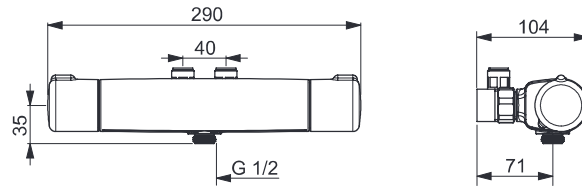

7470X

EN 1111
 I (ISO 3822) Oras lab.
 100 - 1000 kPa
 0.27 l/s (300 kPa)
 165 kPa (0.2 l/s)
 0.19 l/s (Eco-flow at 300 kPa)
 max. +80°C

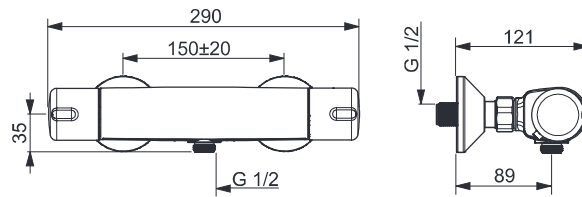

7470U

EN 1111
 I (ISO 3822) Oras lab.
 100 - 1000 kPa
 0.27 l/s (300 kPa)
 165 kPa (0.2 l/s)
 0.19 l/s (Eco-flow at 300 kPa)
 max. +80°C

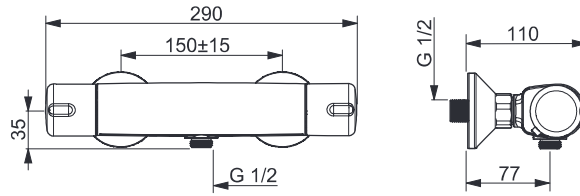

7446X

EN 1111
 I (ISO 3822) Oras lab.
 100 - 1000 kPa
 0.23 l/s (300 kPa)
 230 kPa (0.2 l/s)
 0.16 l/s (Eco-flow at 300 kPa)
 max. +80°C

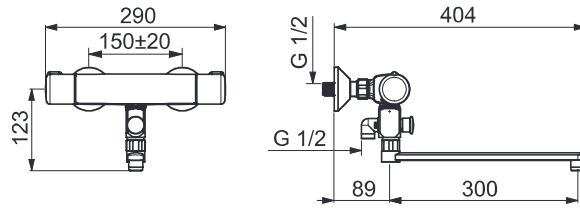

7447X

EN 1111
 I (ISO 3822) Oras lab.
 100 - 1000 kPa
 0.23 l/s (300 kPa)
 230 kPa (0.2 l/s)
 0.16 l/s (Eco-flow at 300 kPa)
 max. +80°C

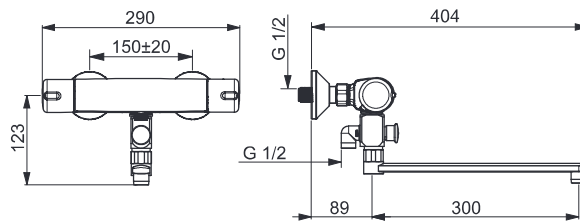

7469

EN 1111
 I (ISO 3822) Oras lab.
 100 - 1000 kPa
 0.27 l/s (300 kPa)
 165 kPa (0.2 l/s)
 0.19 l/s (Eco-flow at 300 kPa)
 max. +80°C

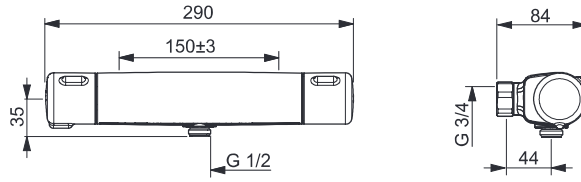

7460X-100

EN 1111
 I (ISO 3822) Oras lab.
 100 - 1000 kPa
 0.27 l/s (300 kPa)
 165 kPa (0.2 l/s)
 0.19 l/s (Eco-flow at 300 kPa)
 max. +80°C

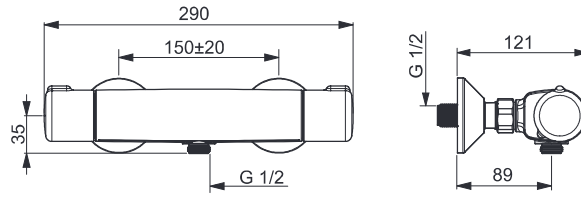

7420

EN 1111
 I (ISO 3822) Oras lab.
 100 - 1000 kPa
 0.12 l/s (300 kPa with flow controller)
 150 kPa (0.2 l/s)
 max. +80°C

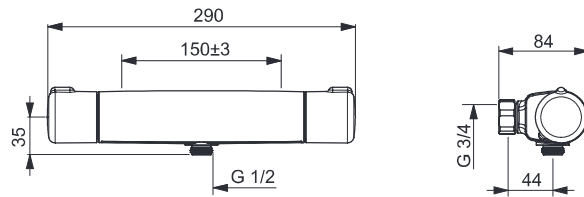

7462

EN 1111
 II (ISO 3822) Oras lab.
 100 - 1000 kPa
 0.33 l/s (300 kPa)
 230 kPa (0.2 l/s)
 0.16 l/s (Eco-flow at 300 kPa)
 max. +80°C

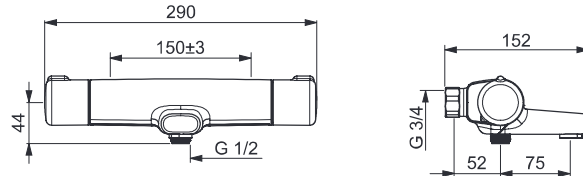

7462G

EN 1111
 I (ISO 3822) Oras lab.
 100 - 1000 kPa
 0.23 l/s (300 kPa)
 230 kPa (0.2 l/s)
 0.16 l/s (Eco-flow at 300 kPa)
 max. +80°C

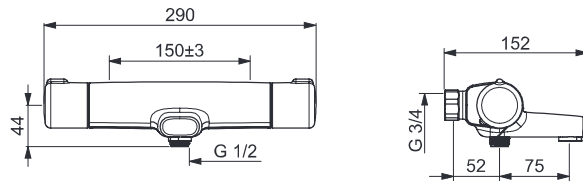

7462U

EN 1111
 I (ISO 3822) Oras lab.
 100 - 1000 kPa
 0.33 l/s (300 kPa)
 300 kPa (0.3 l/s)
 230 kPa (0.2 l/s)
 0.16 l/s (Eco-flow at 300 kPa)
 max. +80°C

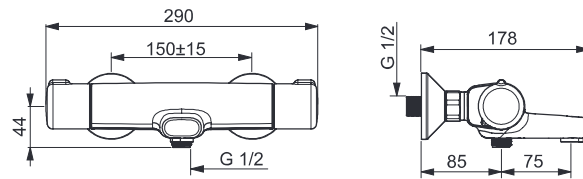

7462X

EN 1111
 II (ISO 3822) Oras lab.
 100 - 1000 kPa
 0.33 l/s (300 kPa)
 300 kPa (0.3 l/s)
 230 kPa (0.2 l/s)
 0.16 l/s (Eco-flow at 300 kPa)
 max. +80°C

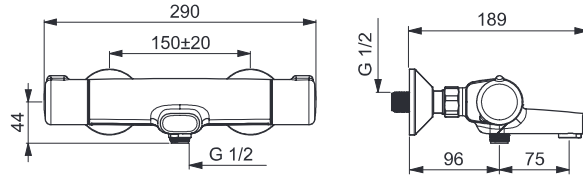

7443

EN 1111
 II (ISO 3822) Oras lab.
 100 - 1000 kPa
 0.33 l/s (300 kPa)
 300 kPa (0.3 l/s)
 230 kPa (0.2 l/s)
 0.16 l/s (Eco-flow at 300 kPa)
 max. +80°C

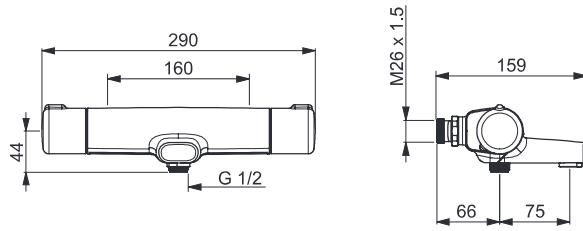

7445

EN 1111
 II (ISO 3822) Oras lab.
 100 - 1000 kPa
 0.3 l/s (300 kPa)
 300 kPa (0.3 l/s)
 0.15 l/s (Eco-flow at 300 kPa)
 max. +80°C

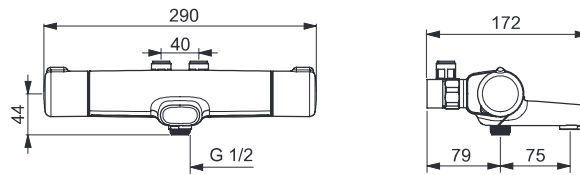

7442U

EN 1111

II (ISO 3822) Oras lab.

100 - 1000 kPa

0.3 l/s (300 kPa)

300 kPa (0.3 l/s)

0.15 l/s (Eco-flow at 300 kPa)

max. +80°C

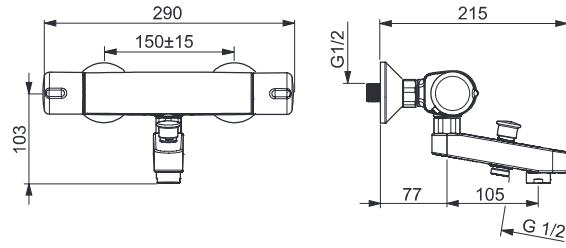

7452X (7460X+530)

EN 1111
 I (ISO 3822) Oras lab.
 100 - 1000 kPa
 0.12 l/s (300 kPa with flow controller)
 max. +80°C

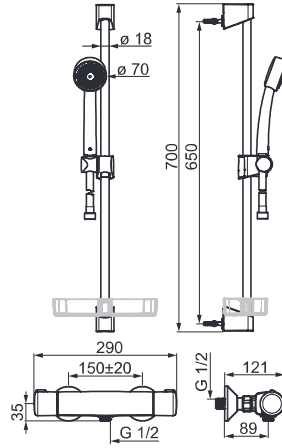

7412 (7460+530)

EN 1111
 I (ISO 3822) Oras lab.
 100 - 1000 kPa
 0.12 l/s (300 kPa with flow controller)
 max. +80°C

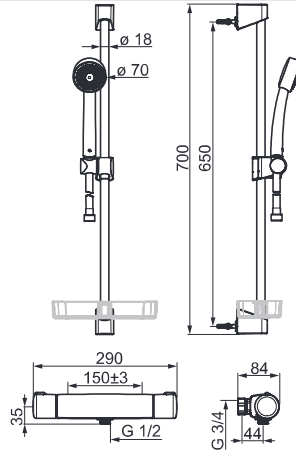

7425 (7460+520)

EN 1111
 I (ISO 3822) Oras lab.
 100 - 1000 kPa
 0.28 l/s (300 kPa)
 0.2 l/s (Eco-flow at 300 kPa)
 155 kPa (0.2 l/s)
 max. +80°C

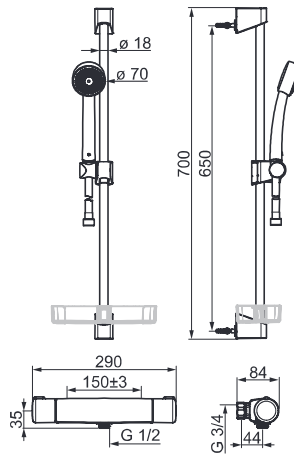

7422 (7464+530)

EN 1111
 I (ISO 3822) Oras lab.
 100 - 1000 kPa
 0.12 l/s (300 kPa with flow controller)
 max. +80°C

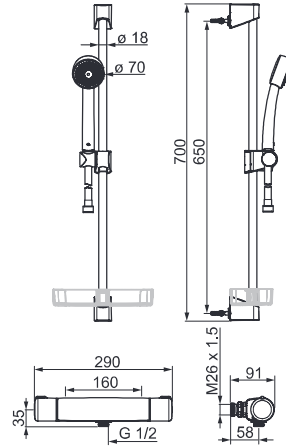

7427 (7464+520)

EN 1111
 I (ISO 3822) Oras lab.
 100 - 1000 kPa
 0.28 l/s (300 kPa)
 0.2 l/s (Eco-flow at 300 kPa)
 155 kPa (0.2 l/s)
 max. +80°C

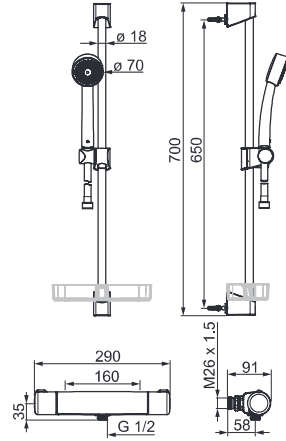

7432 (7466+530)

EN 1111
 I (ISO 3822) Oras lab.
 100 - 1000 kPa
 0.12 l/s (300 kPa with flow controller)
 max. +80°C

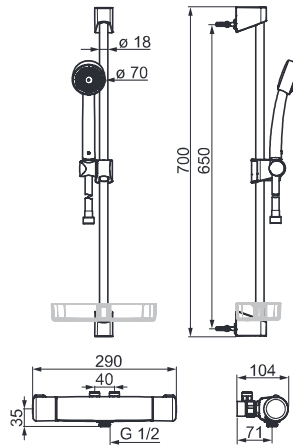

7424 (7466+520)

EN 1111
 I (ISO 3822) Oras lab.
 100 - 1000 kPa
 0.27 l/s (300 kPa)
 0.19 l/s (Eco-flow at 300 kPa)
 160 kPa (0.1 l/s)
 max. +80°C

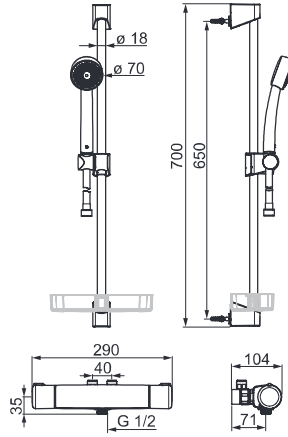

7495 (7461+261033+520)

EN 1111
 I (ISO 3822) Oras lab.
 100 - 1000 kPa
 0.28 l/s (300 kPa)
 0.2 l/s (Eco-flow at 300 kPa)
 155 kPa (0.2 l/s)
 max. +80°C

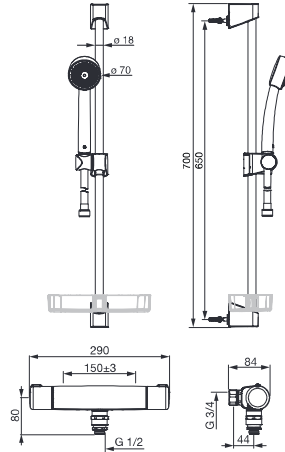

7455 (7461+261033+544)

EN 1111
 I (ISO 3822) Oras lab.
 100 - 1000 kPa
 0.24 l/s (300 kPa)
 0.16 l/s (Eco-flow at 300 kPa)
 210 kPa (0.2 l/s)
 max. +80°C

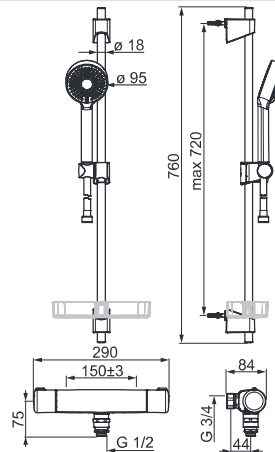

7448 (7462G+261031+520)

EN 1111

I (ISO 3822) Oras lab.

100 - 1000 kPa

0.24 l/s (300 kPa)

0.17 l/s (Eco-flow at 300 kPa)

220 kPa (0.2 l/s)

max. +80°C

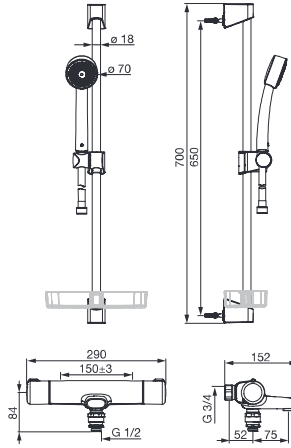

7449 (7462G+350)

EN 1111

I (ISO 3822) Oras lab.

100 - 1000 kPa

0.24 l/s (300 kPa)

0.17 l/s (Eco-flow at 300 kPa)

220 kPa (0.2 l/s)

max. +80°C

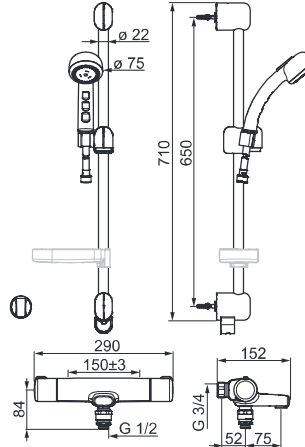

7453 (7462G+544)

EN 1111

I (ISO 3822) Oras lab.

100 - 1000 kPa

0.20 l/s (300 kPa)

0.14 l/s (Eco-flow at 300 kPa)

300 kPa (0.2 l/s)

max. +80°C

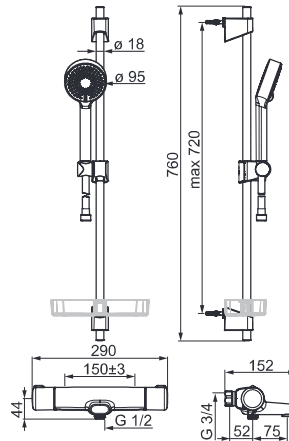

7452U (7460U+530)

EN 1111
 I (ISO 3822) Oras lab.
 100 - 1000 kPa
 0.12 l/s (300 kPa)
 max. +80°C

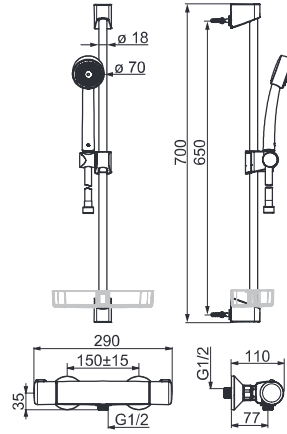

7429 (7460+500)

EN 1111
 I (ISO 3822) Oras lab.
 100 - 1000 kPa
 0.12 l/s (300 kPa with flow controller)
 150 kPa (0.2 l/s)
 max. +80°C

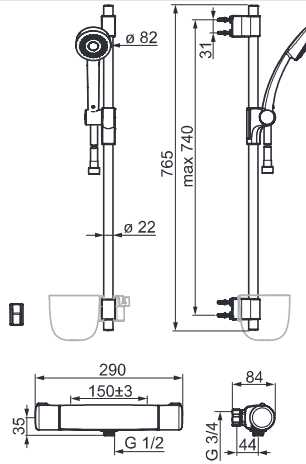

7413 (7460+544)

EN 1111
 I (ISO 3822) Oras lab.
 100 - 1000 kPa
 0.24 l/s (300 kPa)
 0.16 l/s (Eco-flow at 300 kPa)
 210 kPa (0.2 l/s)
 max. +80°C

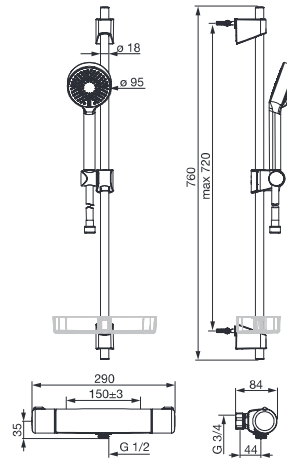

7413U (7460U+544)

EN 1111
 I (ISO 3822) Oras lab.
 100 - 1000 kPa
 0.24 l/s (300 kPa)
 0.16 l/s (Eco-flow at 300 kPa)
 210 kPa (0.2 l/s)
 max. +80°C

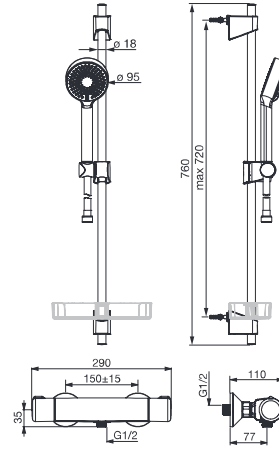

7414 (7462+544)

EN 1111
 II (ISO 3822) Oras lab.
 100 - 1000 kPa
 0.33 l/s (300 kPa)
 0.14 l/s (Eco-flow at 300 kPa)
 300 kPa (0.3 l/s)
 max. +80°C

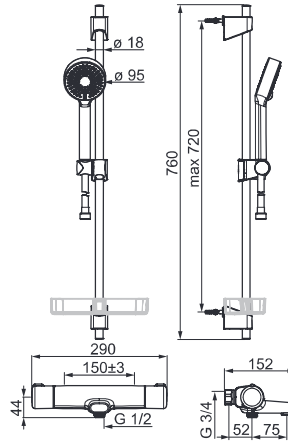

7414U (7462U+544)

EN 1111
 I (ISO 3822) Oras lab.
 100 - 1000 kPa
 0.33 l/s (300 kPa)
 0.14 l/s (Eco-flow at 300 kPa)
 300 kPa (0.3 l/s)
 max. +80°C

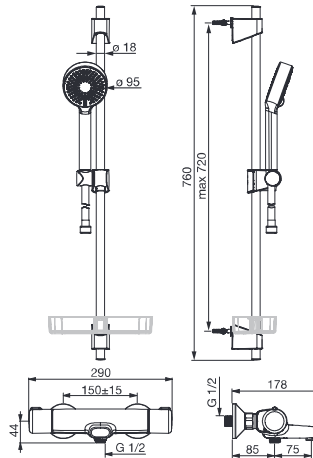

Installation

CZ Montáž	FI Asennus	NL Installatie	SE Installation
DE Montage	FR Installation	NO Montering	SK Inštalácia
DK Installation	IT Montaggio	PL Instalacja	UA Встановлення
EE Paigaldus	LT Montavimas	RO Instalare	
ES Montaje	LV Montāža	RU Установка	



max.
1600 kPa

7470U, 7470X, 7471,
7442U, 7447X,

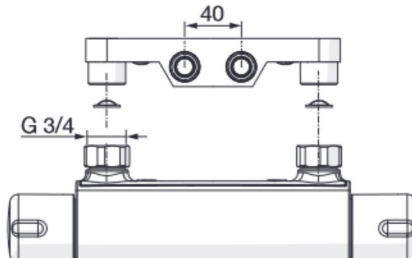
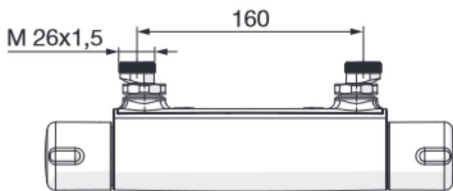
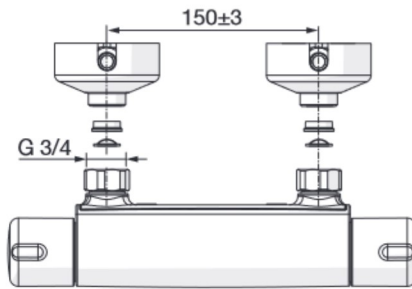
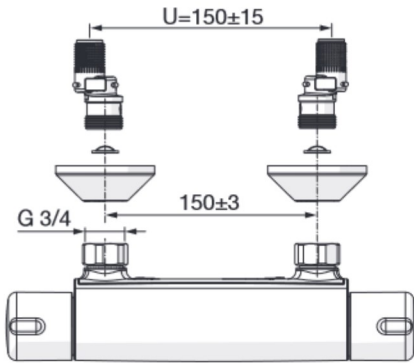
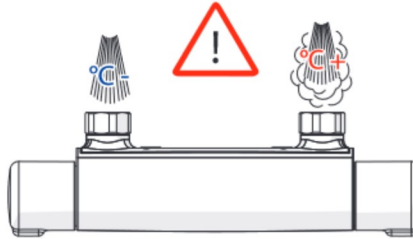
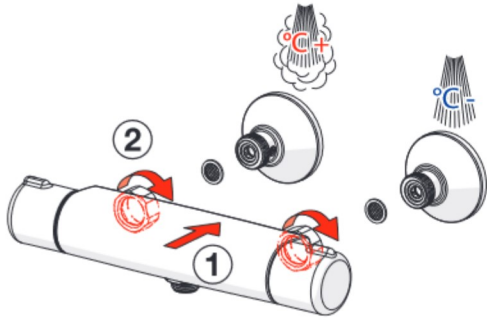

Installation

CZ Montáž	FI Asennus	NL Installatie	SE Installation
DE Montage	FR Installation	NO Montering	SK Inštalácia
DK Installation	IT Montaggio	PL Instalacja	UA Встановлення
EE Paigaldus	LT Montavimas	RO Instalare	
ES Montaje	LV Montāža	RU Установка	

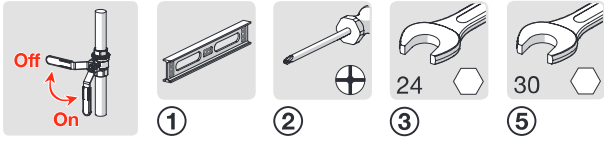

7445 / 7466

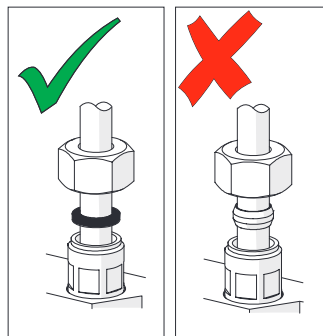
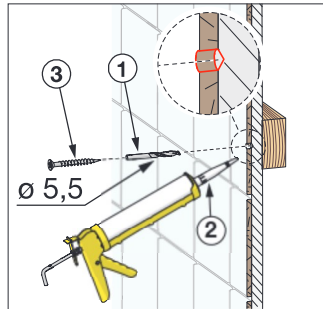
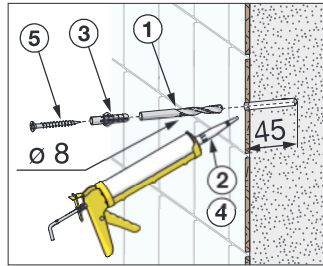
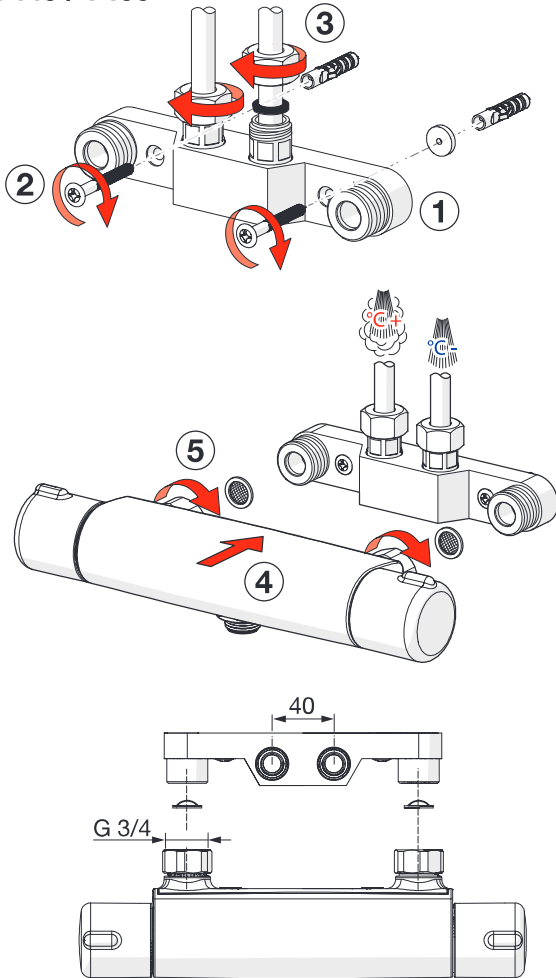

Operation

CZ Funkce	FI Toiminta	NL Bediening	SE Funktion
DE Funktion	FR Utilisation	NO Funksjon	SK Prevádzka
DK Betjening	IT Funzionamento	PL Działanie	UA Принцип дії
EE Toimimine	LT Veikimo principas	RO Funcționare	
ES Servicio	LV Darbības princips	RU Принцип действия	

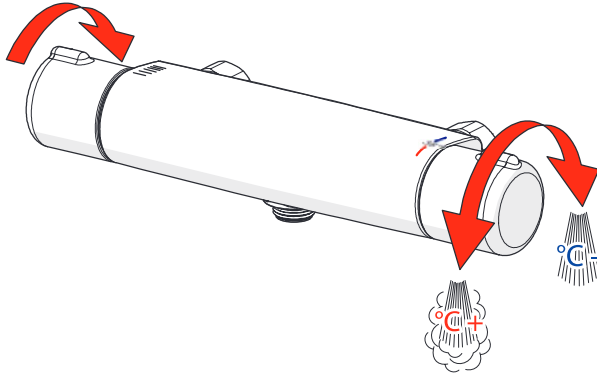
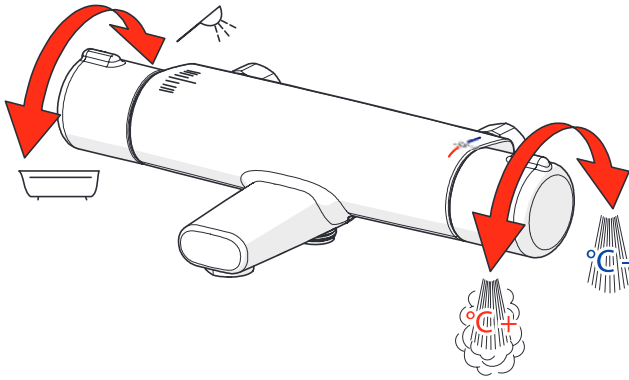

SERVICE 1: Temperature adjustment

CZ Regulátor teploty	LV Temperatūras iestādišana
DE Temperatureinstellung	NL Temperatuursinstelling
DK Justering af temperaturen på installationsstedet	NO Justering av temperaturen ved sperreknappens
EE Temperatuuri seadmine vajadusel	PL Regulacja temperatury
ES Ajuste de la temperatura en el lugar de montaje	RO Reglarea temperaturii
FI Lämpötilan säätö tarvittaessa	RU Регулировка температуры
FR Limitation de la température	SE Justering av blandningstemperatur
IT Regolazione della temperatura sul luogo del montaggio	SK Nastavenie teploty
LT Temperatūros reguliavimas	UA Регулювання температури

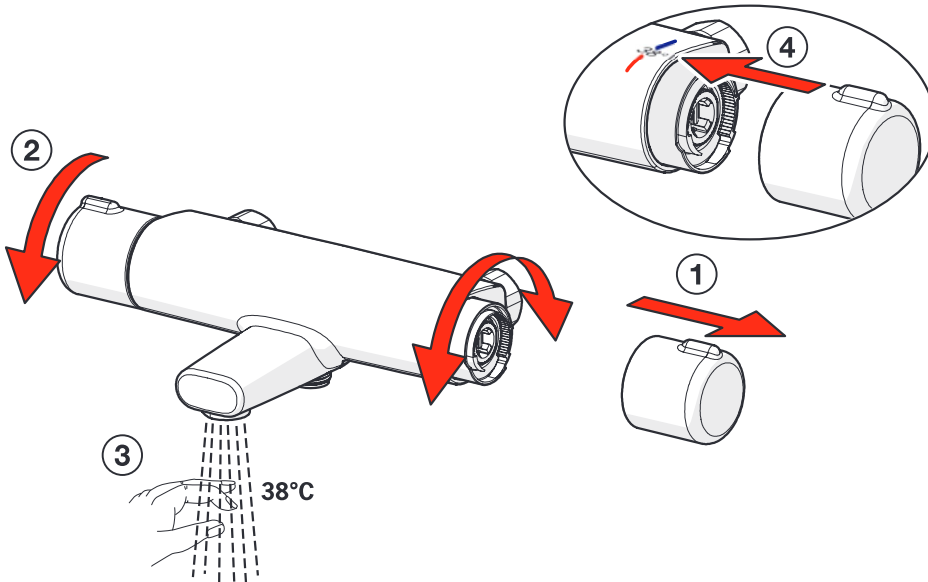

Cleaning/changing the litter filters

CZ Čištění/Výměna filtrů	LV Dubļu filtru tīrīšana/maiņa
DE Reinigung/Wechsel der Filter	NL Reinigen/veranderen van de filters
DK Rensning/udskiftning af filtre	NO Rensing/bytting av filter
EE Prügipüüduuri puhastamine/vahetamine	PL Czyszczenie/wymiana filtra
ES Limpieza/cambio de los filtros	RO Curățirea/înlocuirea filtrelor
FI Roskasiivilöiden puhdistaminen/vaihtaminen	RU Очистка и замена уплотнительных фильтров
FR Nettoyage/changement des filtres	SE Rengöring/byte av smutsfilter
IT Pulizia/sostituzione dei filtri	SK Čistenie/výmena odpadových filtrov
LT Filtrų valymas ir pakeitimas	UA Чищення та заміна ущільнюючих фільтрів

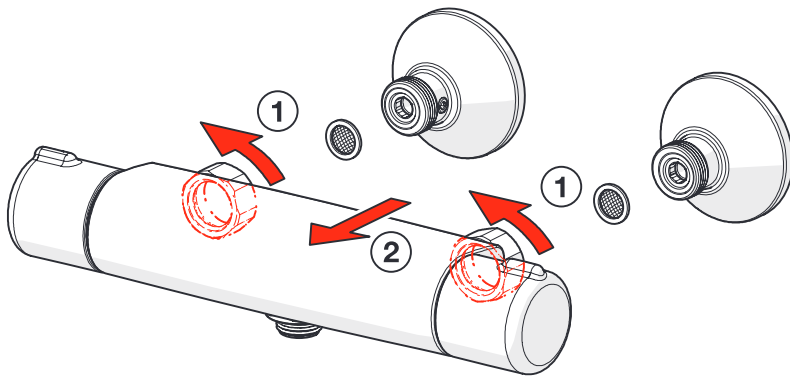
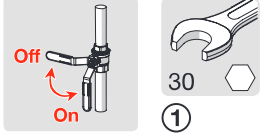

To change the cartridge

CZ Výměna kartuše	LV Regulēšanas mehānisma kasetes maiņa
DE Ein- und Ausbau der Kartusche	NL Vervangen van het keramische binnenwerk
DK Udskiftning af reguleringskassette (unit)	NO Skifting av kassett
EE Seadeosa vahetus	PL Wymiana modułu sterującego
ES Montaje del cartucho	RO Înlocuirea cartușului
FI Säättöosan vaihto	RU Замена регулировочного блока
FR Montage et démontage de la cartouche	SE Byte av kassett
IT Montaggio della cartuccia	SK Výměna kartuše
LT Valdančiosios kasetės pakeitimas	UA Заміна регулювального блоку

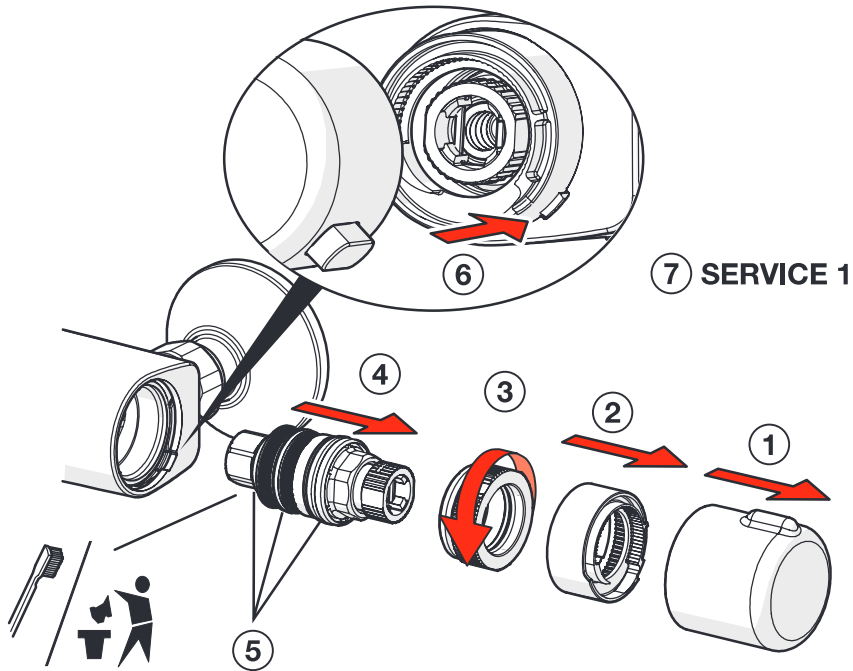
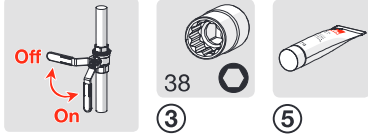

Changing the operating valve

CZ Výměna pracovního ventilu
DE Auswechseln der keramischen Oberteile
DK Udskiftning af topstykker
EE Seadeventiili vahetus
ES Recambio del cartucho del monoblock
FI Käyttöventtiilin vaihto
FR Changement de la tête ceramique eau chaude ou eau froide du grand bec
IT Sostituzione dei vitoni in ceramica
LT Vandens srauto reguliavimo ventilio pakeitimas

LV Ūdens plūsmas ventīļa maiņa
NL Vervangen van de werkingsklep
NO Bytting av overdel
PL Wymiana zaworu regulacyjnego
RO Înlocuirea ventilului de operare
RU Замена узла управления потоком воды
SE Byte av kranöverdel
SK Výměna prevádzkového ventilu
UA Заміна вузла управління потоком води

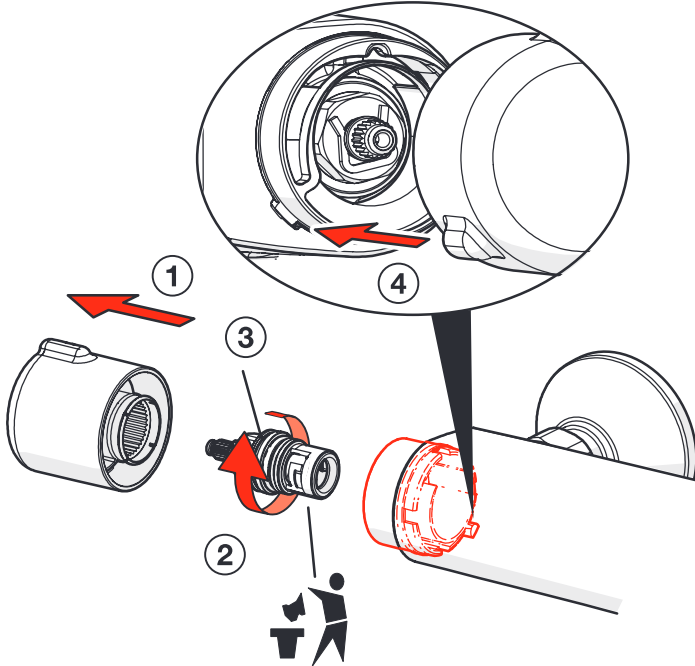
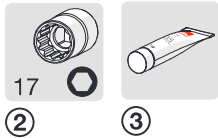
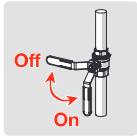

Changing the diverter

CZ Výměna přepínače	FR Changement de l'inverseur	PL Wymiana przełącznika
DE Wartung des Umstellers	IT Sostituzione della deviatore	RO Înlocuirea divertorului
DK Udskiftning af omskifter	LT Perjungiklio pakeitimas	RU Замена переключателя
EE Suundvahetaja vahetamine	LV Trīseju vārsts maiņa	SE Byte av omkastare
ES Cambiar la inversor	NL Omsteller vervangen	SK Výměna prepínača
FI Vaihtimen vaihto	NO Bytting av omkaster	UA Заміна перемикача

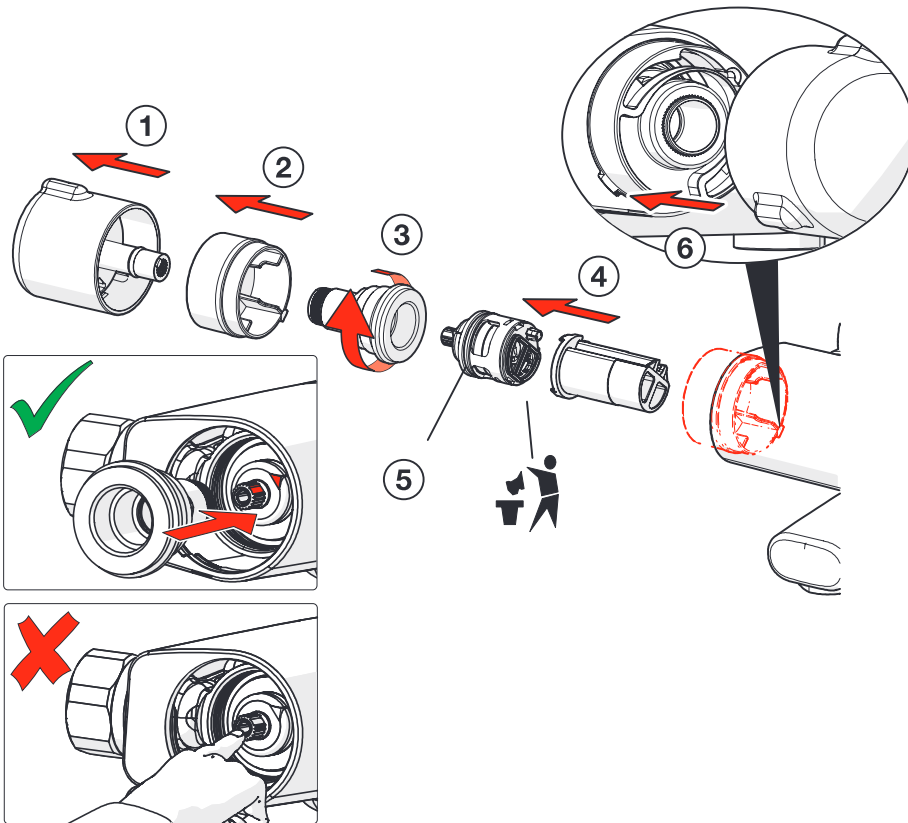
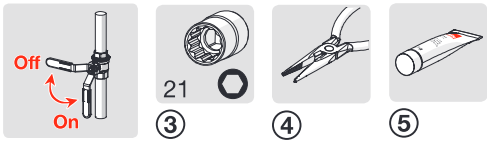

Cleaning the faucet

CZ Čištění baterie	FR Nettoyage du robinet	PL Czyszczenie baterii
DE Reinigung der Armatur	IT Pulizia della rubinetteria	RO Curățire
DK Rengøring af armaturet	LT Maišytuvo valymas	RU Чистка смесителя
EE Puhastamine	LV Krāna tīrīšana	SE Rengöring av blandarna
ES Limpieza de la grifería	NL Reinigen van de kraan	SK Čistenie vodovodnej batérie
FI Puhdistus	NO Rengjøring av kranen	UA Чищення змішувача

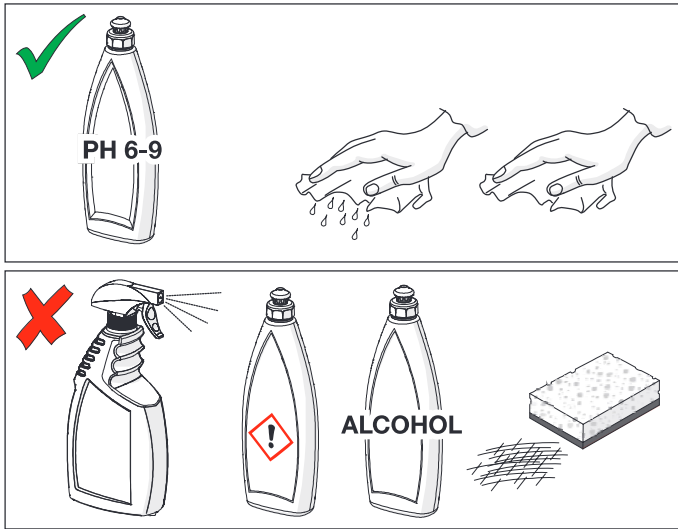

Cleaning/changing the aerator

CZ Čištění/Výměna perlátoru	IT Pulizia/Sostituzione dell'aeratore
DE Reinigung/Wechseln des Luftsprudlers	NL Reinigen/veranderen van de perlator
DK Rensning/Udskiftning af perlator	NO Rensing/Bytting av strålesamler
ES Limpieza/Cambiar el aireador	PL Czyszczenie/Wymiana perlatora
FI Poresuuttimen puhdistaminen/vaihtaminen	PT Limpar/substituir o arejador
FR Nettoyage/Changement de l'aérateur	RU Очистка и замена аэратора
GR Καθαρισμός/αλλαγή αεριστήρα	SE Rengöring/Byte av strålsamlare
HU Az aerátor tisztítása/cseréje	SK Čistenie/Výmena perlátora

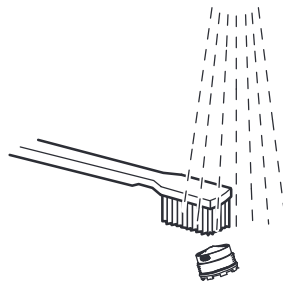

Spare parts

CZ Náhradní díly	FI Varaosat	NL Reserveonderdelen	RU Запасные части
DE Ersatzteile	FR Pièces détachées	NO Reservedeler	SE Reservdelar
DK Reservedele	IT Pezzi di ricambio	PL Części zamienne	SK Náhradné diely
EE Varuosad	LT Atsarginės dalys	RO Piese de schimb	UA Запасні частини
ES Piezas de recambio	LV Rezerves daļas		

**7452U, 7460, 7460X-100, 7460U, 7460X,
7461, 7484, 7464, 7466, 7446X, 7420, 7429,
7413, 7413U**

- 1 602430V
- 2 109898
- 3 178375V
- 3 198094/2 (SE)
- 4 602431V
- 5 178796V
- 6 178780V

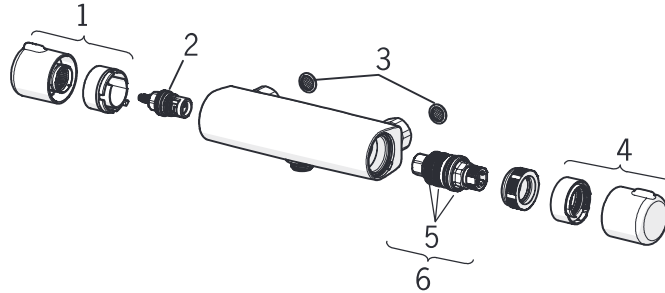

**7462, 7462G, 7462U, 7462X, 7445,
7443, 7414, 7414U, 7453**

- 1 602452V
- 2 601278V
- 3 178375V
- 3 198094/2 (SE)
- 4 602431V
- 5 178796V
- 6 178780V
- 7 158556
- 7 600654V (7462G)

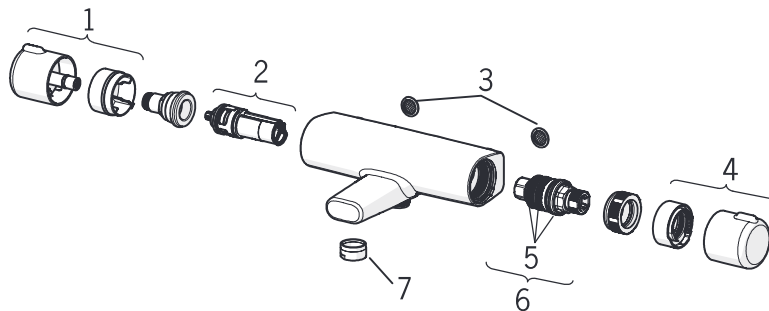

Spare parts

CZ Náhradní díly	FI Varaosat	NL Reserve- onderdelen	RU Запасные части
DE Ersatzteile	FR Pièces détachées	NO Reservedeler	SE Reservdelar
DK Reservedele	IT Pezzi di ricambio	PL Części zamienne	SK Náhradné diely
EE Varuosad	LT Atsarginės dalys	RO Piese de schimb	UA Запасні частини
ES Piezas de recambio	LV Rezerves daļas		

7470U, 7470X, 7471, 7442U, 7447X

- 1 602431V
- 2 109898
- 3 178375V
- 4 602430V
- 5 178796V
- 6 178780V

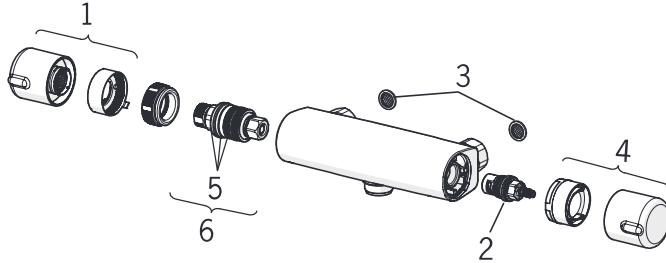

7469

- 1 602430V
- 2 109898
- 3 178375V
- 4 602602V
- 5 178796V
- 6 178780V

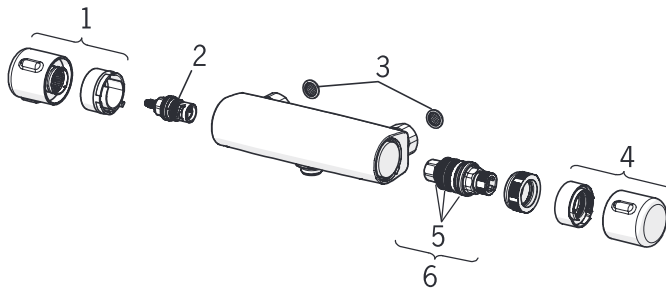

Oras Group is a powerful European provider of sanitary fittings: the market leader in the Nordics and a leading company in Continental Europe. The company's mission is to make the use of water easy and sustainable and its vision is to become the European leader of advanced sanitary fittings. Oras Group has two strong brands, Oras and Hansa.

The head office of the Group is located in Rauma, Finland, and the Group has four manufacturing sites: Burglengenfeld (Germany), Kralovice (Czech Republic), Olesno (Poland) and Rauma (Finland). Oras Group employs approximately 1400 people in twenty countries. Oras Group is owned by Oras Invest, a family company and an industrial owner.

ORAS GROUP

Isometsäntie 2, P.O. Box 40

FI-26101 Rauma

Tel. +358 2 83 161

Fax +358 2 831 6300

info.finland@oras.com

www.oras.com



Water Is Worth Loving.

943213/03/17